

- Ultrasonic level transmitter
- Range 0.05 ÷ 1.5 meters
- Blind zone 5 cm
- IP68
- Suitable for measuring of liquids
- Comm. Protocol MODBUS RTU
- Power supply 24 Vdc
- Output: 4 ÷ 20 mA analogue output



Non-intrusive level measurement systems are the preferred technology for many applications and for this reason it developed these level/distance transmitters. These units are compact with a unique simplicity of commissioning. Calibration and transmitter configuration is possible, even remotely, thanks to a MODBUS RTU connection together with the related software for the PC, or via display unit. The IP68 transmitter protection allows installation in underground wells.

TECHNICAL FEATURES

Housing material
PP

Mechanical installation
1" GAS M - PP flange DN100/125 opt.

Protection degree
IP68

Electrical connection
IP68 male connector with 5/10/15/20m linking cable

Working temperature
-25 ÷ +75°C

Pressure
From 0,5 to 1,5 bar (absolute)

Power supply
24Vdc

Power consumption
1.5W

Analog output
4÷20mA max 750ohm

Digital communication
MODBUS RTU

Range
0.05÷1.5m

In case of non perfectly reflecting surfaces, the maximum distance value will be reduced

Temperature compensation
digital in the working temperature

Accuracy
±0,2% (of the measured distance) not better than ±3mm

Resolution
1mm

Calibration
Prog. module with 4 buttons or by MODBUS

Warm-up
30 minutes

Display
matrix LCDdisplay on module (opt.)

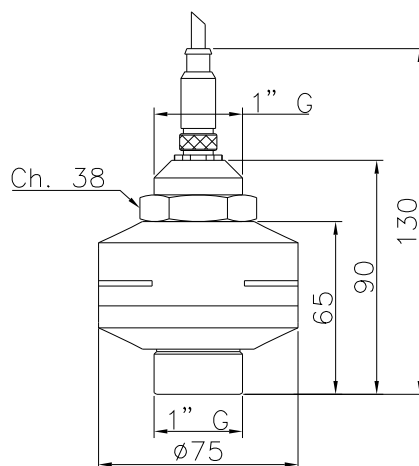

Level transmitter

Ultrasonic - for measurement in liquids, muds and acids;
 Range: 0,05 ÷ 1,5m; IP68 proof
 Housing in polypropylene (PP)
 Calibration by units or via MODBUS
 Power supply 24Vdc - Output 4÷20mA + MODBUS
 Temperature range -25 ÷ +75°C

Version	
E	With SS316 male connector
Z	Special
Process connection / Sensor material	
0	G 1" / PP + n. 1 1" BSP / PP fixing bolt
1	DN100 PN6 UNI 1092-1 flange / PP
9	Special
Accessories	
A	None
F	MODBUS PC communication S/W (010F105A)
H	Extension for PTU5x L=250mm in PP + DN100 flange
L	Adjustable extension for PTU5x in PP + DN100 flange (Lmin= 85mm Lmax=690mm)
T	IP68 female connector with 5m linking cable
U	IP68 female connector with 10m linking cable
V	IP68 female connector with 15m linking cable
W	IP68 female connector with 20m linking cable
Z	Special